

C-WING  
1st FLOOR PLAN

Area Statement in Sq. Mtr.

Flat No.	Type	Flat Carpet Area (Sq. Mtr. )	Balcony Carpet Area (Sq. Mtr. )	Terrace Carpet Area (Sq. Mtr. )	Total Carpet Area (Sq. Mtr. )
101	3.5-BHK	72.13	19.97	4.88	96.98
102	3.5-BHK	68.39	22.18	4.88	95.46
103	2.5-BHK	54.06	11.53	3.90	69.48
104	2.5-BHK	56.73	8.75	3.90	69.38





## C-WING

### 2nd FLOOR PLAN

#### Area Statement in sq. Mtr.

Flat No.	Type	Flat Carpet Area (Sq. Mtr. )	Balcony Carpet Area (Sq. Mtr. )	Terrace Carpet Area (Sq. Mtr. )	Total Carpet Area (Sq. Mtr. )
201	3-BHK	67.14	18.04	6.97	92.15
202	3-BHK	63.37	20.27	6.97	90.61
203	2-BHK	49.88	9.25	6.50	65.63
204	2-BHK	54.11	5.02	6.50	65.63





## C-WING

3rd, 5th, 7th,  
9th & 11th  
FLOOR PLAN

Area Statement in Sq. Mtr.						
Flat No.	Type	Flat Carpet Area (Sq. Mtr. )	Balcony Carpet Area (Sq. Mtr. )	Terrace Carpet Area (Sq. Mtr. )	Total Carpet Area (Sq. Mtr. )	
301,501,701,901,1101	3-BHK	67.14	18.04	4.88	90.06	
302,502,702,902,1102	3-BHK	63.34	20.28	4.88	88.50	
303,503,703,903,1103	2-BHK	49.88	9.25	3.90	63.03	
304,504,704,904,1104	2-BHK	54.11	5.02	3.90	63.03	



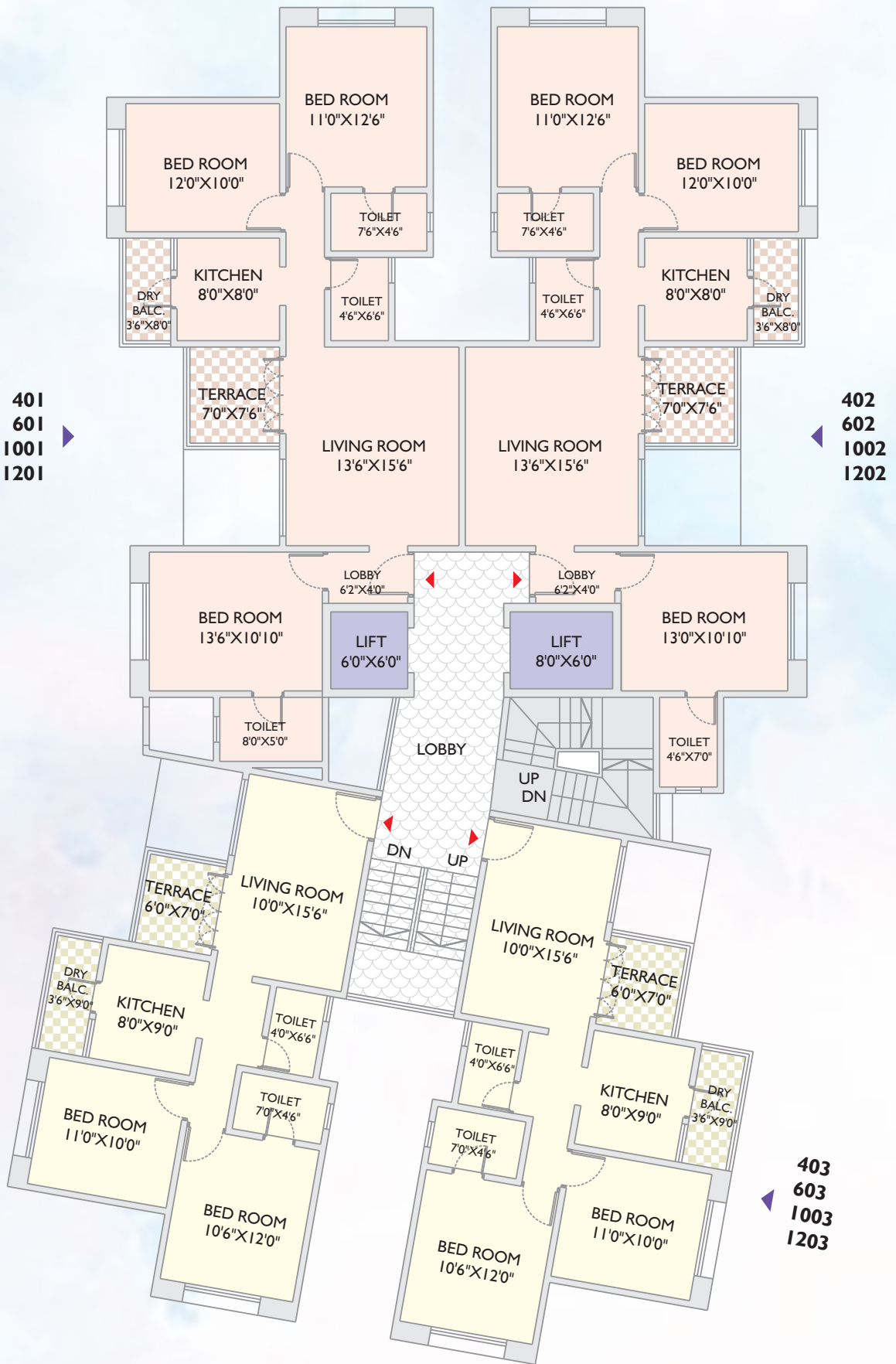

## C-WING

4rd, 6th, 10th,  
& 12th FLOOR PLAN

Area Statement in Sq. Mtr.

Flat No.	Type	Flat Carpet Area (Sq. Mtr. )	Balcony Carpet Area (Sq. Mtr. )	Terrace Carpet Area (Sq. Mtr. )	Total Carpet Area (Sq. Mtr. )
401,601,1001,1201	3-BHK	67.16	18.02	4.88	90.05
402,602,1002,1202	3-BHK	63.37	20.28	4.88	88.53
403,603,1003,1203	2-BHK	49.88	9.25	3.90	63.03
404,604,1004,1204	2-BHK	54.11	5.02	3.90	63.03







C-WING  
8th FLOOR PLAN

Area Statement in Sq. Mtr.					
Flat No.	Type	Flat Carpet Area (Sq. Mtr. )	Balcony Carpet Area (Sq. Mtr. )	Terrace Carpet Area (Sq. Mtr. )	Total Carpet Area (Sq. Mtr. )
801	3-BHK	67.14	18.04	4.88	90.06
802	2-BHK	49.31	15.25	4.88	69.44
803	2-BHK	49.88	9.25	3.90	63.03
804	2-BHK	54.11	5.02	3.90	63.03

